

# *Easy & Fast!*

*The most advanced  
door opening technology*



One action to open or close  
(Push-Pull lever)



Fast and accurate  
fingerprint authentication



\*Real-time arrival  
notification\*



\*Mobile app to unlock  
the door lock

\* 'Real-time arrival notification' and 'Mobile app to unlock the door lock' above are available with the IoT Service Pack, which is separately sold.

**new**

# Make your life easier than ever with peace of mind

SHP-DP609



## Easy and Fast

### Push-Pull lever

Simply push or pull the big lever to open or close the door.



### Fingerprint access

Just one touch with your finger to unlock the door with fast and accurate fingerprint sensor.



### Voice guide

Spoken feedback to guide the user for setup and ongoing use.



### Welcome function

Approaching the door will automatically activate the touch pad allowing convenient passcode entry.



### LED status icons

Display the door lock status, such as Intrusion alarm, Low battery notification, Do not enter mode, etc.



## Security and Safety

### Intrusion alarm

Attempted forced entry or tampering to pass the door lock will set off the alarm immediately.



### Away mode

Once you set 'vacation mode', the door lock will alarm if anyone opens the door from inside.

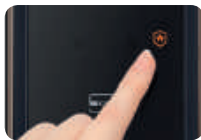

### Data security

#### Passwords protection from Mobile App

: If you lose your mobile phone, you can delete the existing passcode and create new via mobile app.



#### White Box Cryptography

: Prevents the exposure of private information, such as passcode, to minimize security risks.

#### Secure Encapsulation for Application Layer (SEAL)

: Provides an up-to-date and secure app environment with state of the art data security technology.

#### App hardening

: Used to protect its software data by modifying an application's binary code to make it more resistant to reverse-engineering, tampering and intrusion.



## Mobile Application Services (Wi-Fi)

※ The specific features in this section below are available with the IoT Service Pack, which is separately sold.

### Access log

Check who/when entered or left your home with mobile application.



### Smart open

Whether you are out of home, you can remotely unlock the door lock with mobile application.

\* Available only on 'Samsung Smart Doorlock' (mobile application)

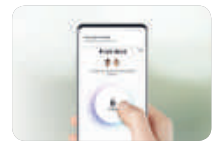

### Smart bell

When your visitor rings the bell by touching the smart bell icon on the door lock, you will receive a push message in real-time.

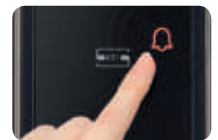

### Duration Key

Regular visitor can enter your home with duration key at certain period of time.



### One-time passcode (OTP)

Issue one-time passcode for your visitor with mobile application.



2480\*



Free download the mobile app 'Samsung Smart Lock' from the Apple App Store™ or Google Play™ for Smart IoT Features.



## Specification

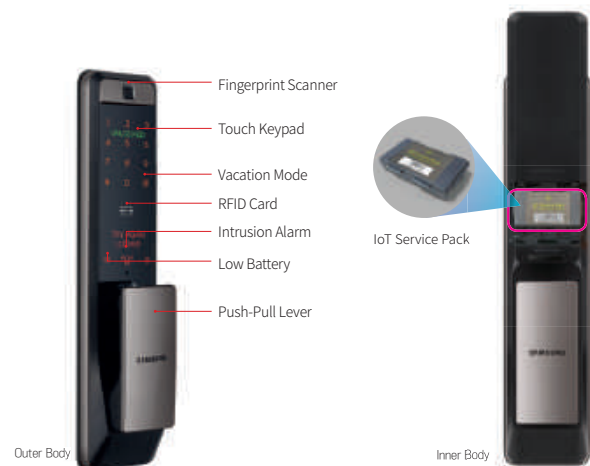

- Battery Alkaline 1.5V AA Battery (LR6) x 8
- Product Size (including handle)
  - Inner 88(W) x 392.1(H) x 63.8(D)mm
  - Outer 86.2(W) x 391(H) x 68.5(D)mm

\* The content of this page is subject to change without prior notice to the user in order to enhance the performance of the product.